

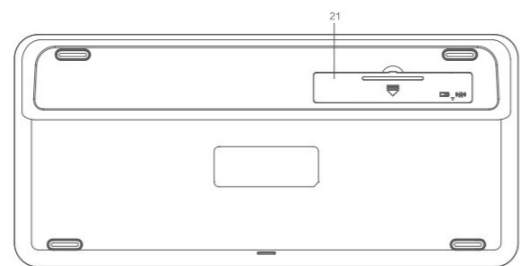

2E Wireless keyboard KS 250 Black

Manual

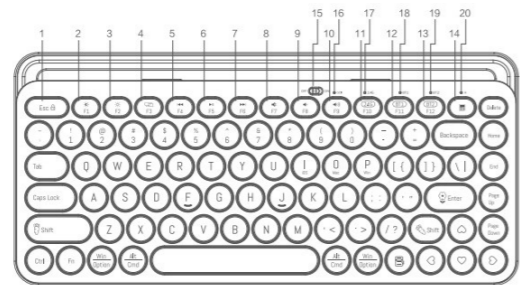
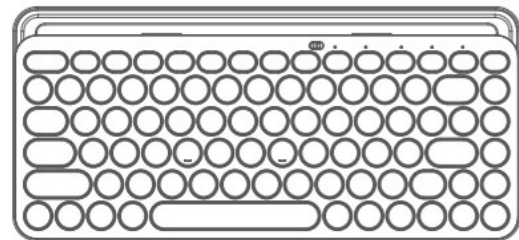

Function overview of the keyboard

1	Lock fn function	8	Mute	15	ON/OFF Switch
2	Screen brightness -	9	Volume-	16	Low battery indicator
3	Screen brightness +	10	Volume+	17	2.4G wireless mode indicator
4	Multiscreen display	11	2.4G wireless mode	18	Bluetooth mode 1 indicator
5	Prev track	12	Bluetooth mode 1	19	Bluetooth mode 2 indicator
6	Play/Pause	13	Bluetooth mode 2	20	Caps lock indicator
7	Next track	14	Calculator	21	Battery door

2.4G wireless connection guide

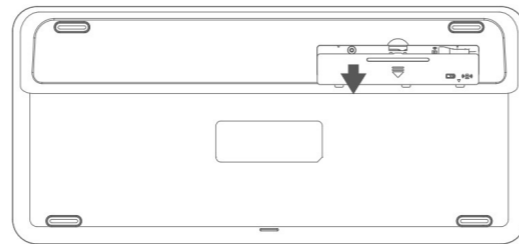

Push the battery door away

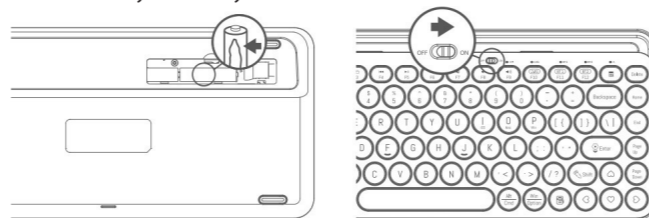

Pull off the battery insulating film. Insert battery in keyboard. Turn on the power switch.

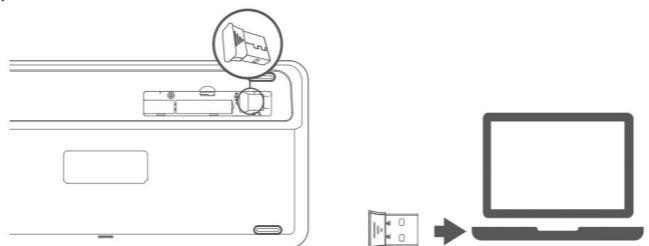

1. Take out receiver and close the battery door
2. Plug the receiver into the USB port of a PC
3. Note: The factory default setting of the connection mode of keyboard is 2.4G mode.

Keyboard Bluetooth connection guide

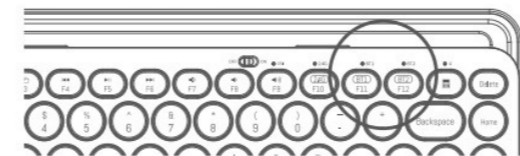

Note: Make sure that the keyboard power is on before Bluetooth pairing.

1. Select the Bluetooth mode to be connected, short press the mode key, and the corresponding indicator on the top will flash slowly
2. Long press the Bluetooth mode switch key again, and the corresponding indicator on the top will flash quickly, and then enter the waiting for Bluetooth pairing.
3. Turn on the Bluetooth of your computer or other devices, search and select «BT3.0 KB» or «BT5.0 KB» and start Bluetooth pairing until the connection is completed.

Note: Bluetooth 5.0 is not supported on Windows 7 and below; The device ID for Bluetooth 3.0 - «BT3.0 KB» while for 5.0 - «BT5.0 KB»

Mode switching method of the keyboard

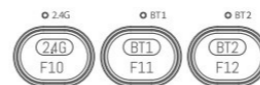

1. The keyboard has three channels: 2.4G, Bluetooth 1 and Bluetooth 2, which can connected three devices at the same time.
2. Mode switching. Short press the mode switch button, the corresponding mode indicator on the top will be ON for 3 seconds and then it will be off. The switch to the corresponding equipment is completed. If the mode indicator is flashing slowly, it means that the mode has been connect.

iOS/Mac/Win layout switch

Press and hold for 3 seconds to switch the system layout



Note: default settings is Windows layout..

F1-F12/ multimedia function switch



1. The factory default setting of F1-F12/multimedia function keys is multimedia function.



2. Press this key combination and switch to F1-F12 function. Press it again to switch back to multimedia function.

Note: multimedia functions are partly invalid in different OS versions

Sleep Mode

1. When the keyboard stops working for 30 minutes, it will automatically enter the sleep mode and the indicator light will go out.
2. If you want to use the keyboard again, you only need to press any key and the keyboard will wake up within 3 seconds.
3. The indicator light lights up again and starts to work.

Packaging contents:

1. Wireless keyboard
2. 2.4G receiver
3. Manual
4. Battery 2xAAA

System requirement

1. 1xUSB port
2. Bluetooth 3.0/Bluetooth 5.0
3. Windows 7/8/10 or later, Android 3.2 and above, Mac OS 10.5 or later

Technical specifications

1. Connectivity: 2.4G/ Bluetooth 3.0/ Bluetooth 5.0
2. Working distance: 2.4 GHz about 15 m/ Bluetooth about 10m
3. Keyboard keys lifespan: 10 million keystrokes
4. Power supply: 2xAAA battery
5. Keyboard size: 314 x 145x 24 mm
6. Product weight: 797 g

Trouble shooting

1. Make sure that the USB wireless receiver of the product plugged correctly into the USB port of the computer.
2. Make sure the computer meets the minimum system requirement.
3. If the distance between the product and the receiver exceeds an effective range, please reduce the distance for better performance.

Attention!

1. Please use dry and soft cloth to clean the product.
2. Do not disassemble the product by force.
3. Do not get in the rain of in the sun or fire.
4. Do not flush directly with water.